

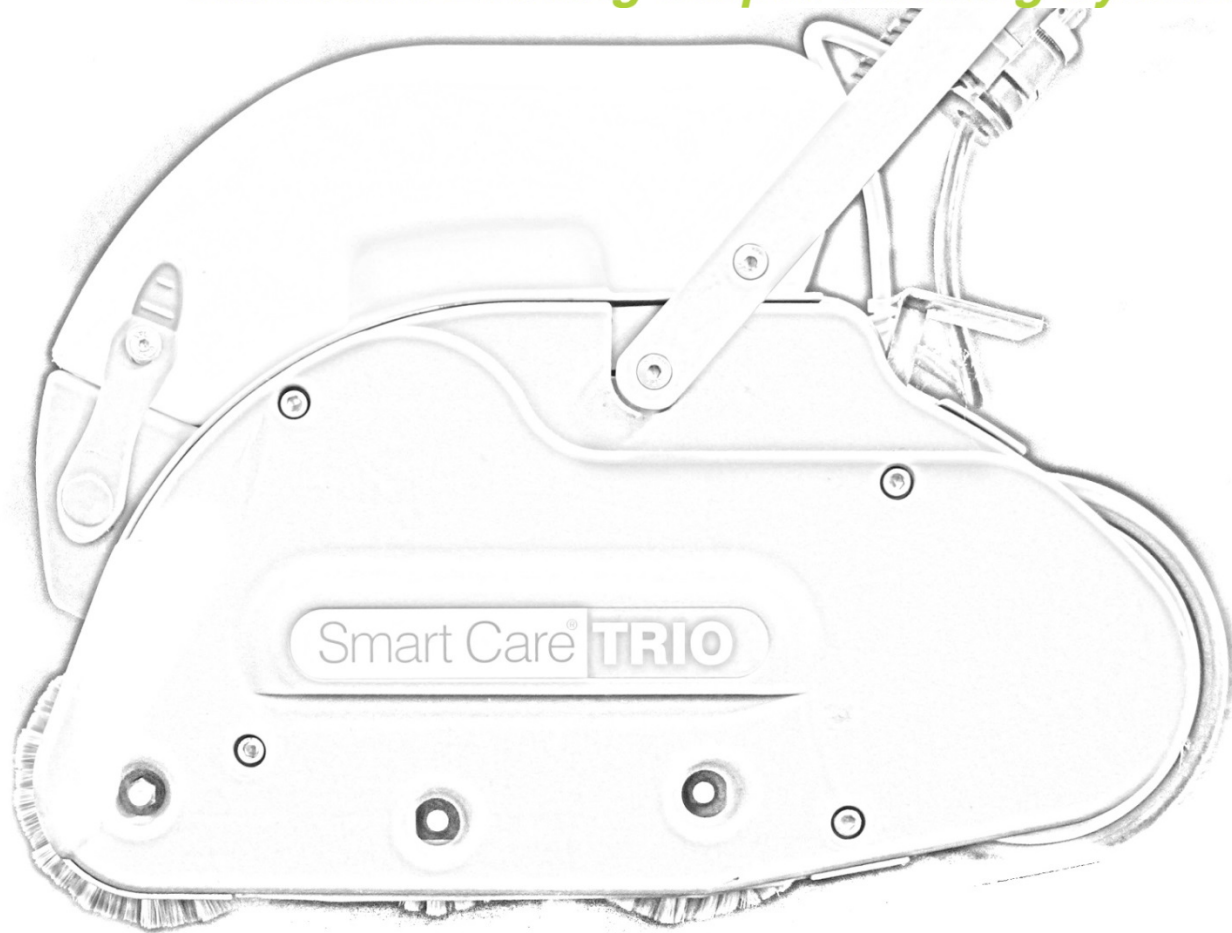

# whittaker

*America's Leading Carpet Cleaning System™*



# Smart Care® TRIO

## Replacing Gears

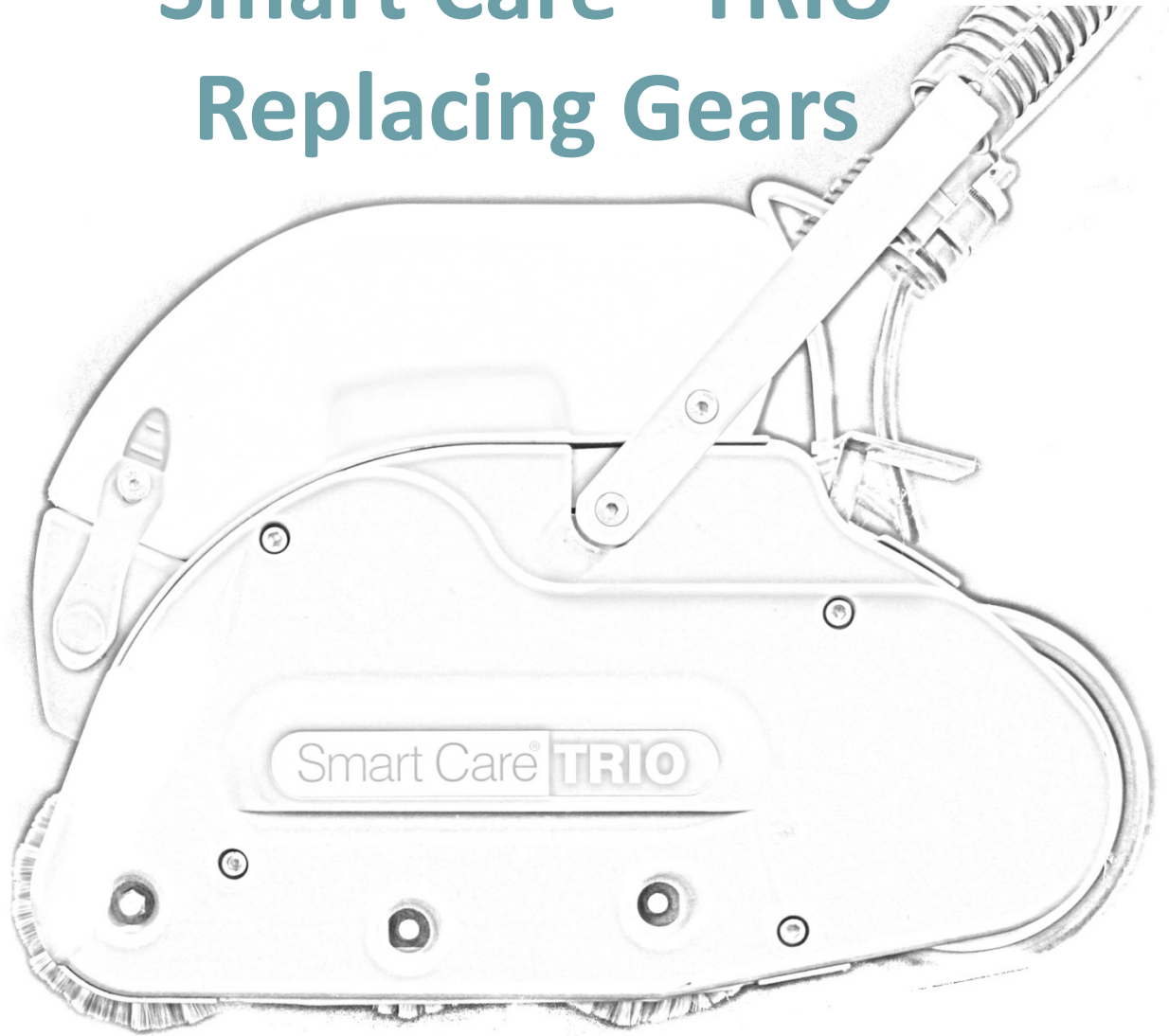

Place TRIO on work bench





Remove plug from plug holder





1 – Depress Foot pedal & move lower handle assembly to run position

2 - Remove the 4 drive cover assembly screws

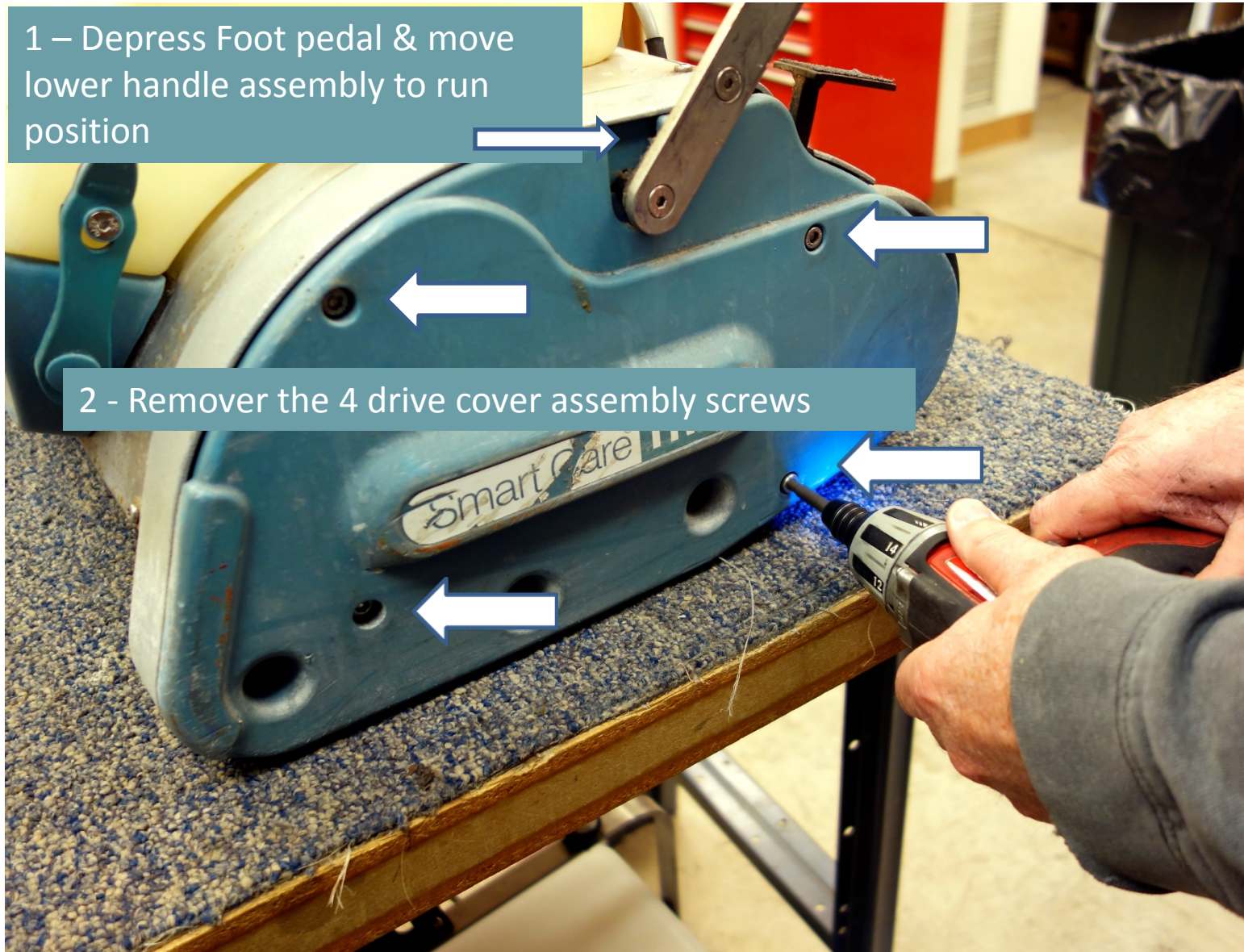



Remove drive cover assembly

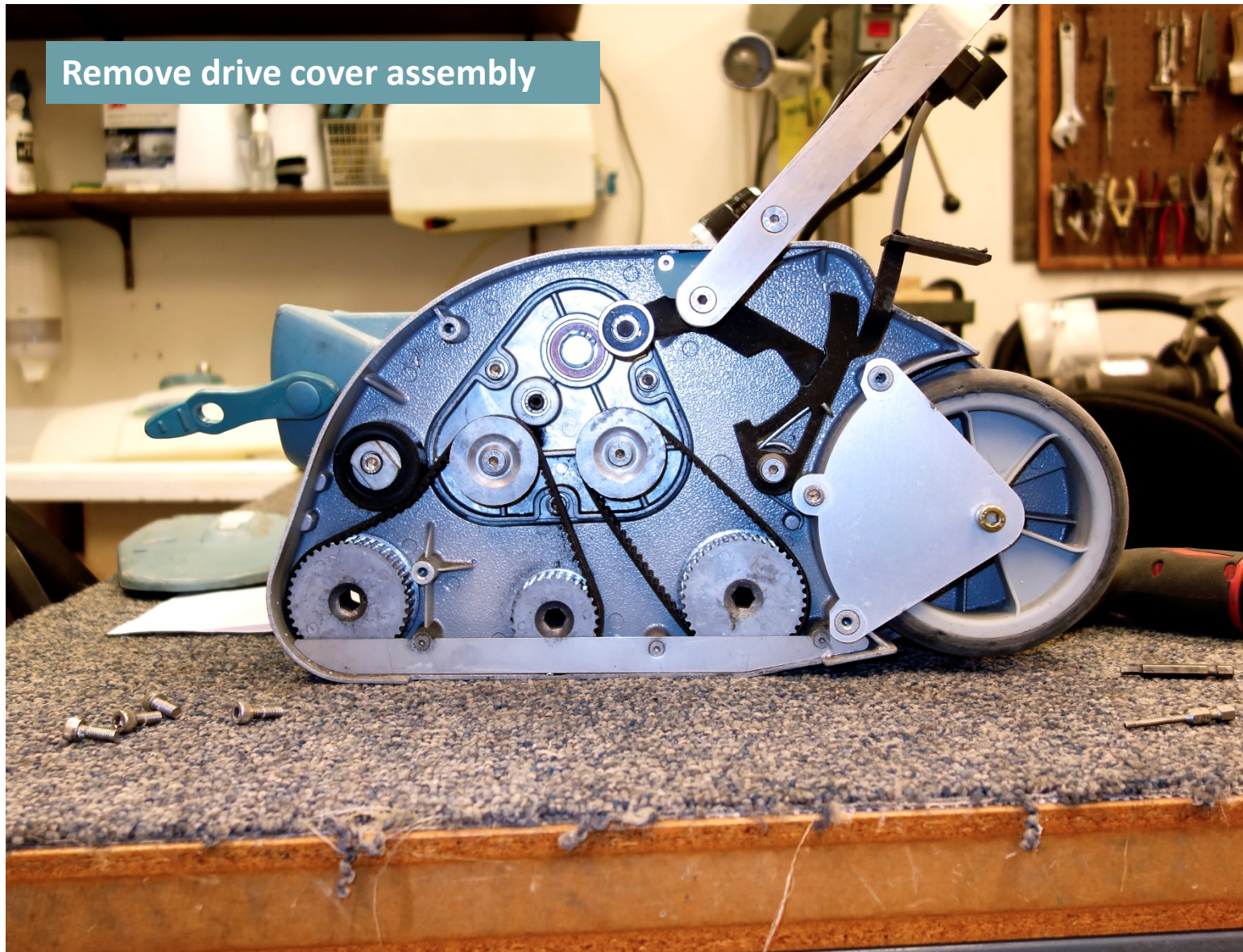



Remover belt shield

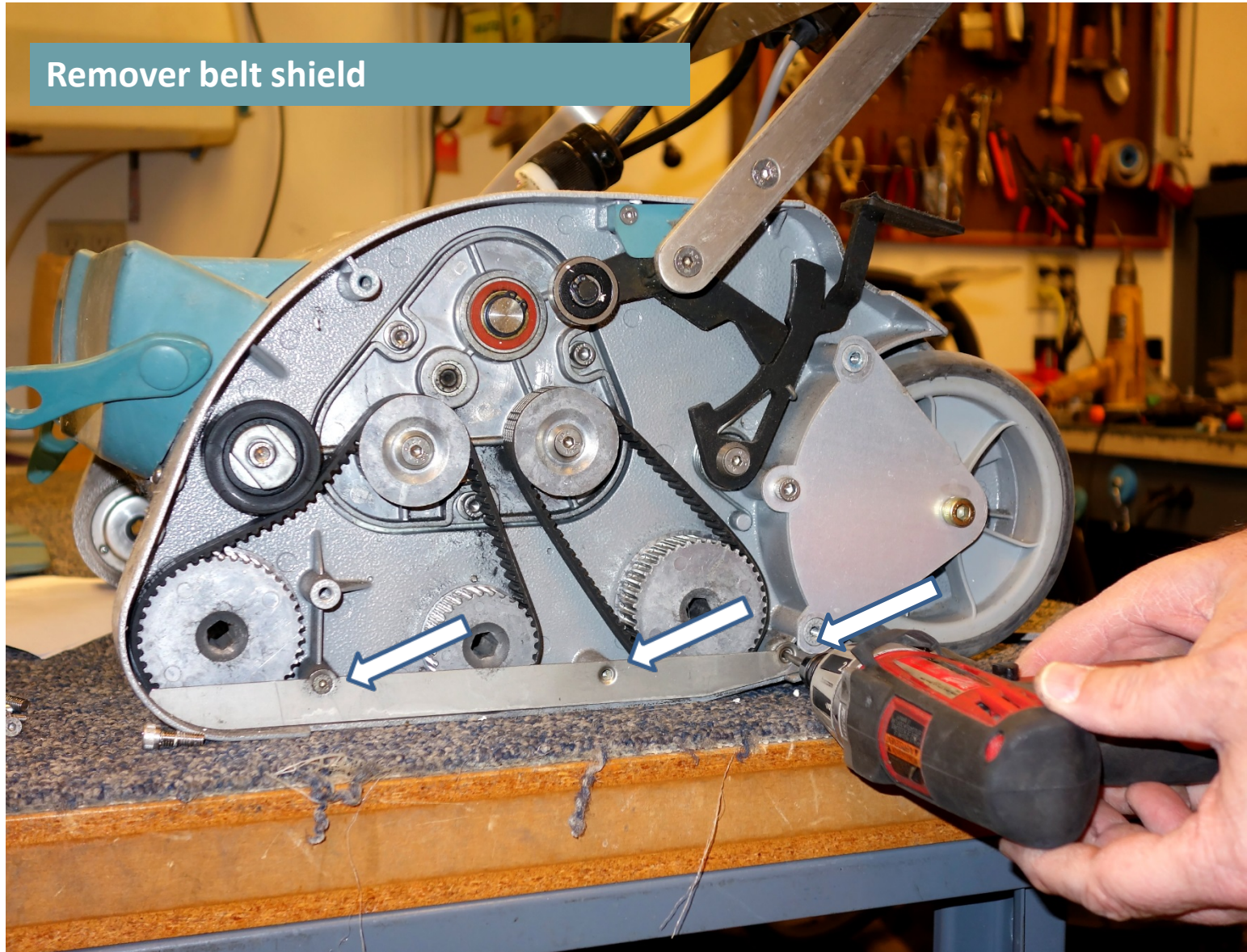



Loosen idler assembly





Loosen gear housing

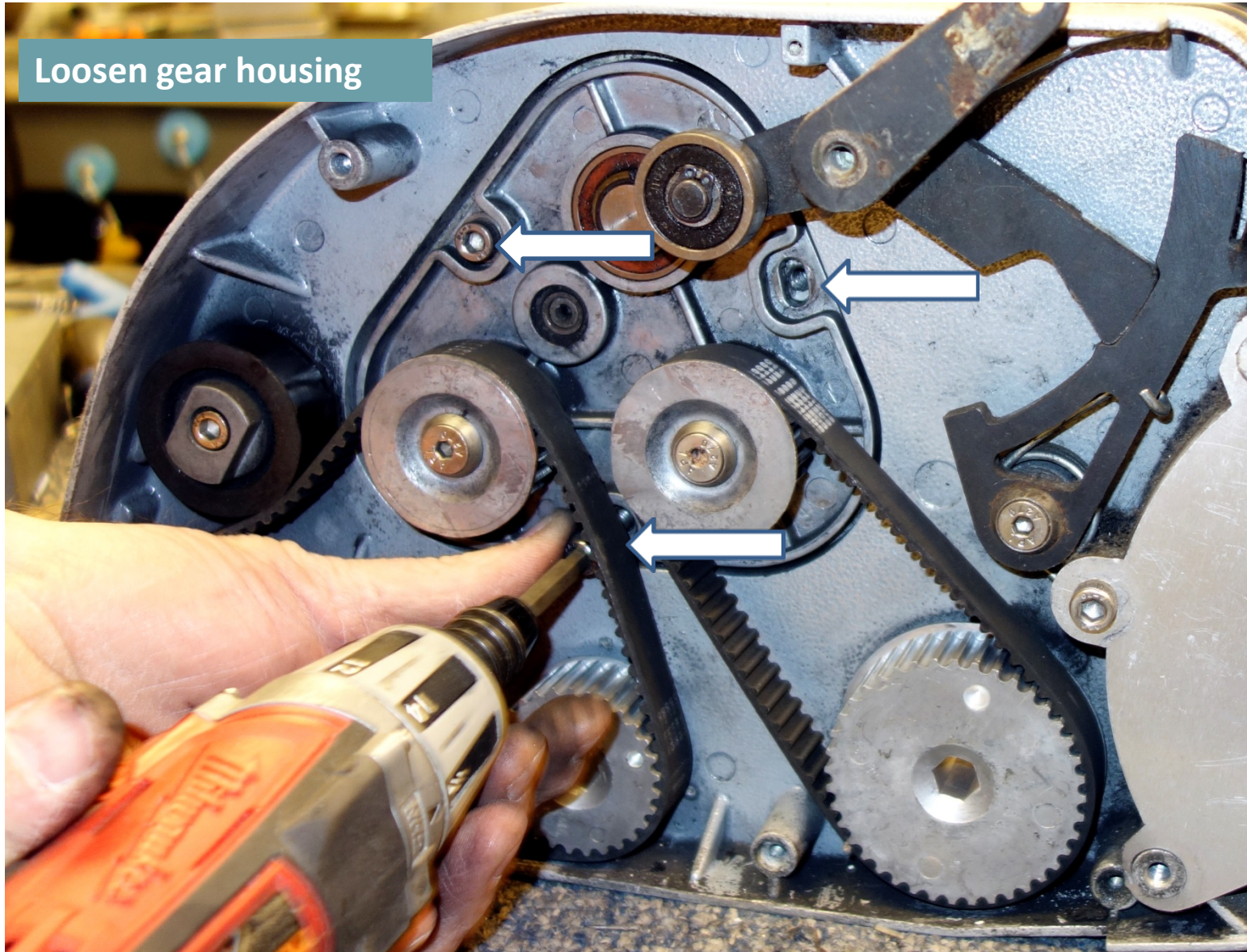



Partially remove gear housing,  
remove the belts





Remove gear housing from side housing assembly. Note stripped gears!





Remove damaged gear(s)





Install new gear(s)





Use thread locker on gear screws





Screw the gears in place. Use a paper towel between the gears to facilitate tightening the screws

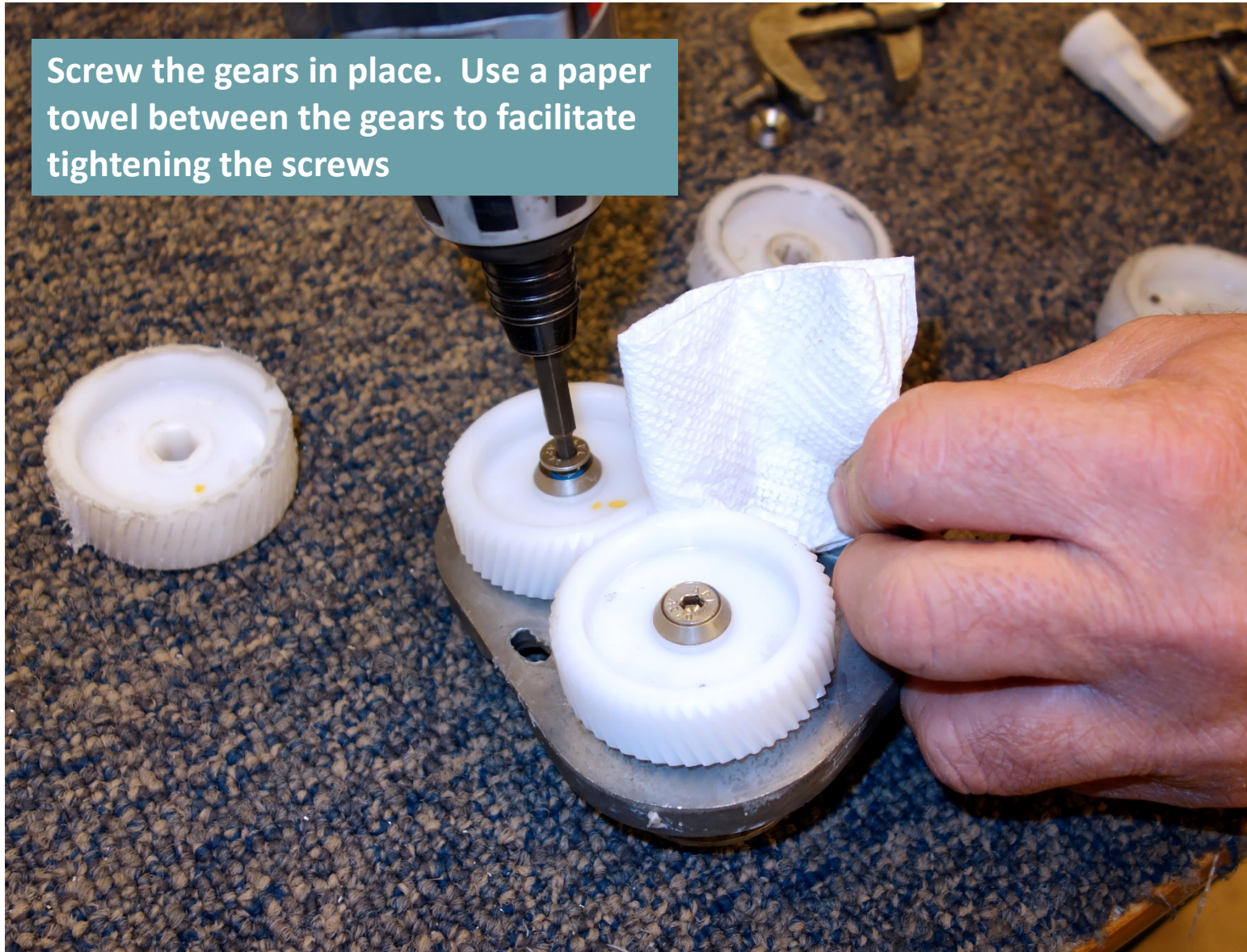



Please note there are 2 Yellow dot right hand gears and 1 Blue dot left hand gear. The orientation is shown below. The gear housing fits into drive housing only one way, as shown.

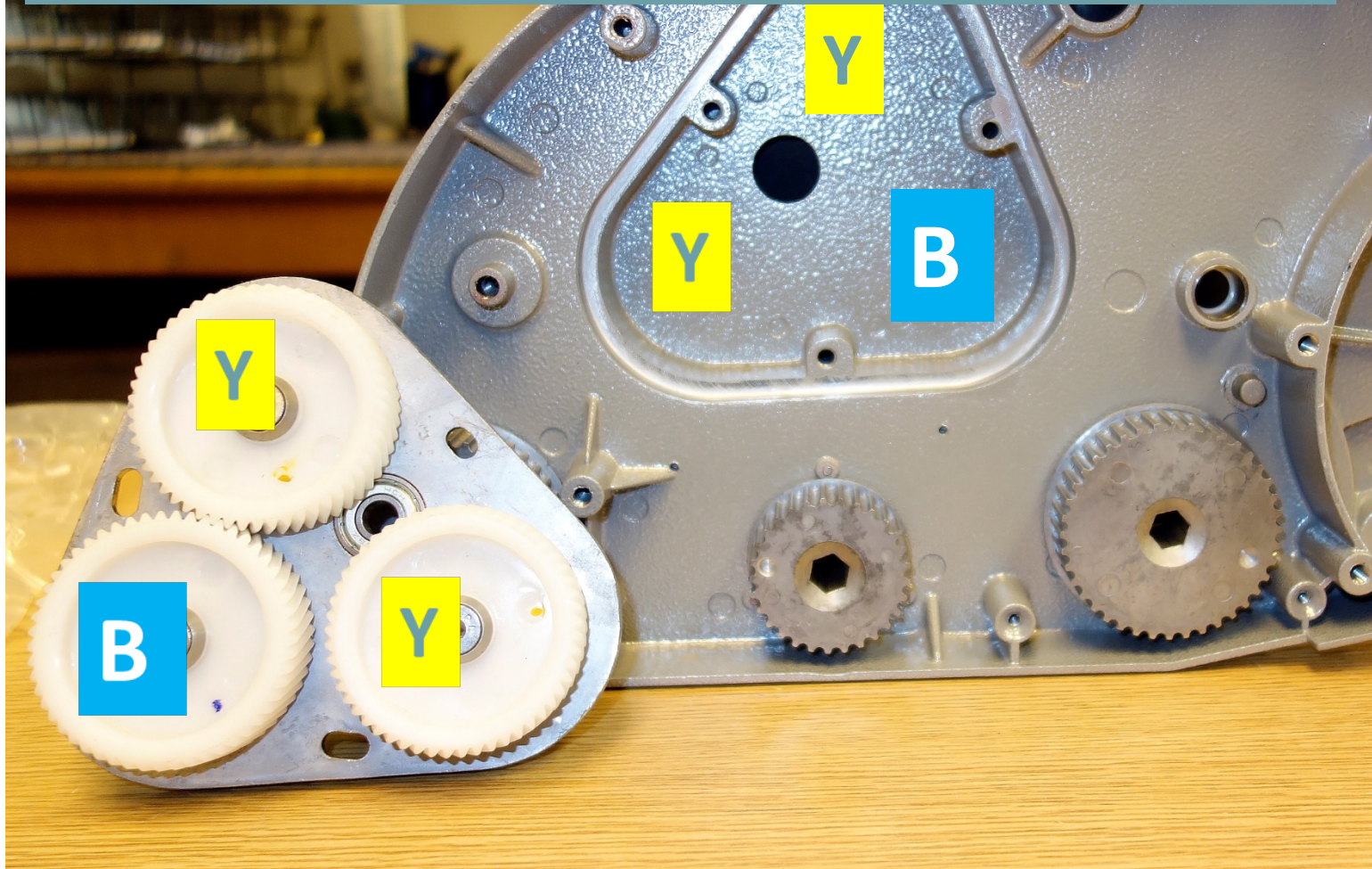



Replace gear housing and belts





Replace the 3 screws then use a screwdriver to lift gear housing to tighten belt as shown. Then tighten screws while still lifting with screwdriver

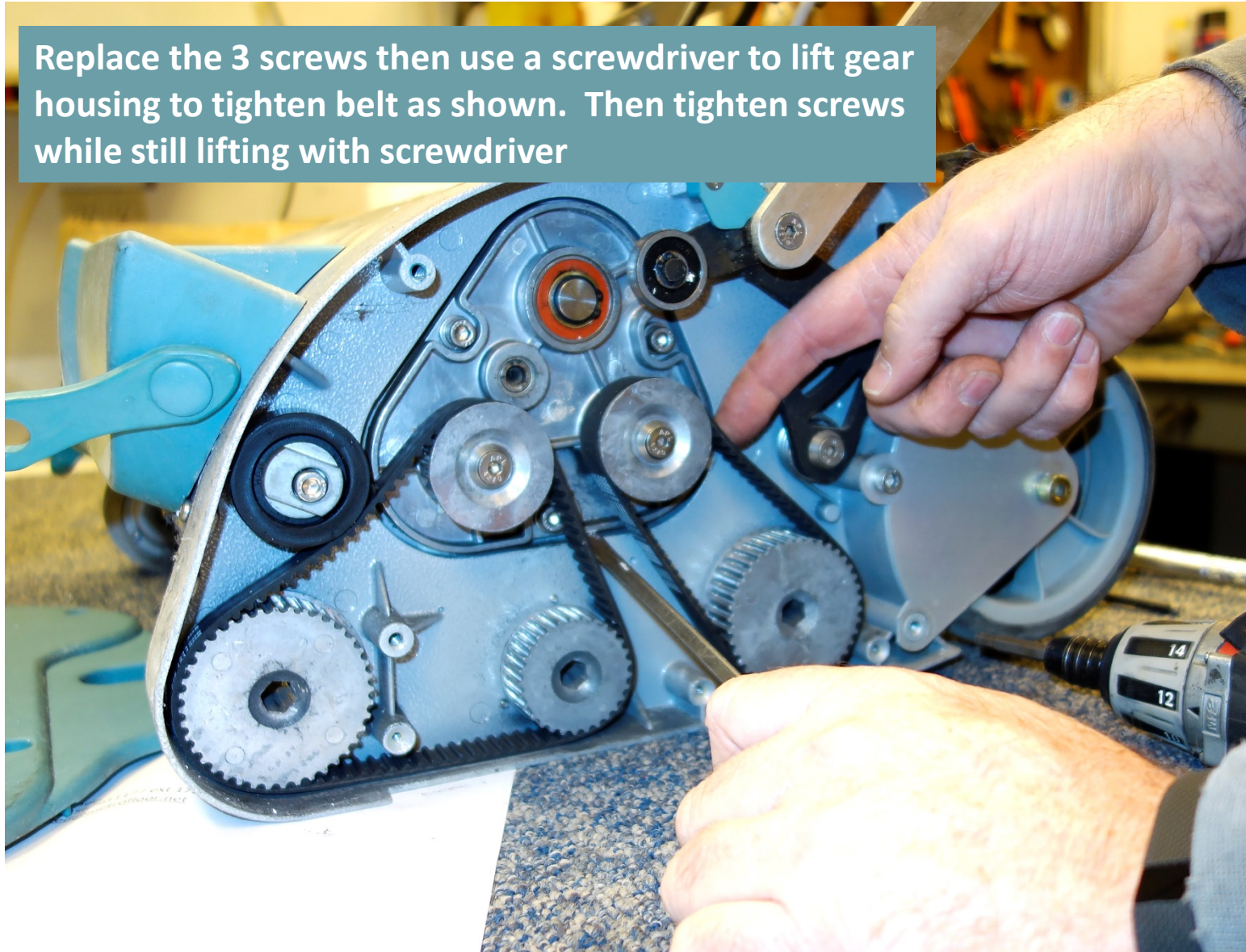



Rotate idler assembly to tighten belt then  
tighten idler assembly screw





Replace belt shield

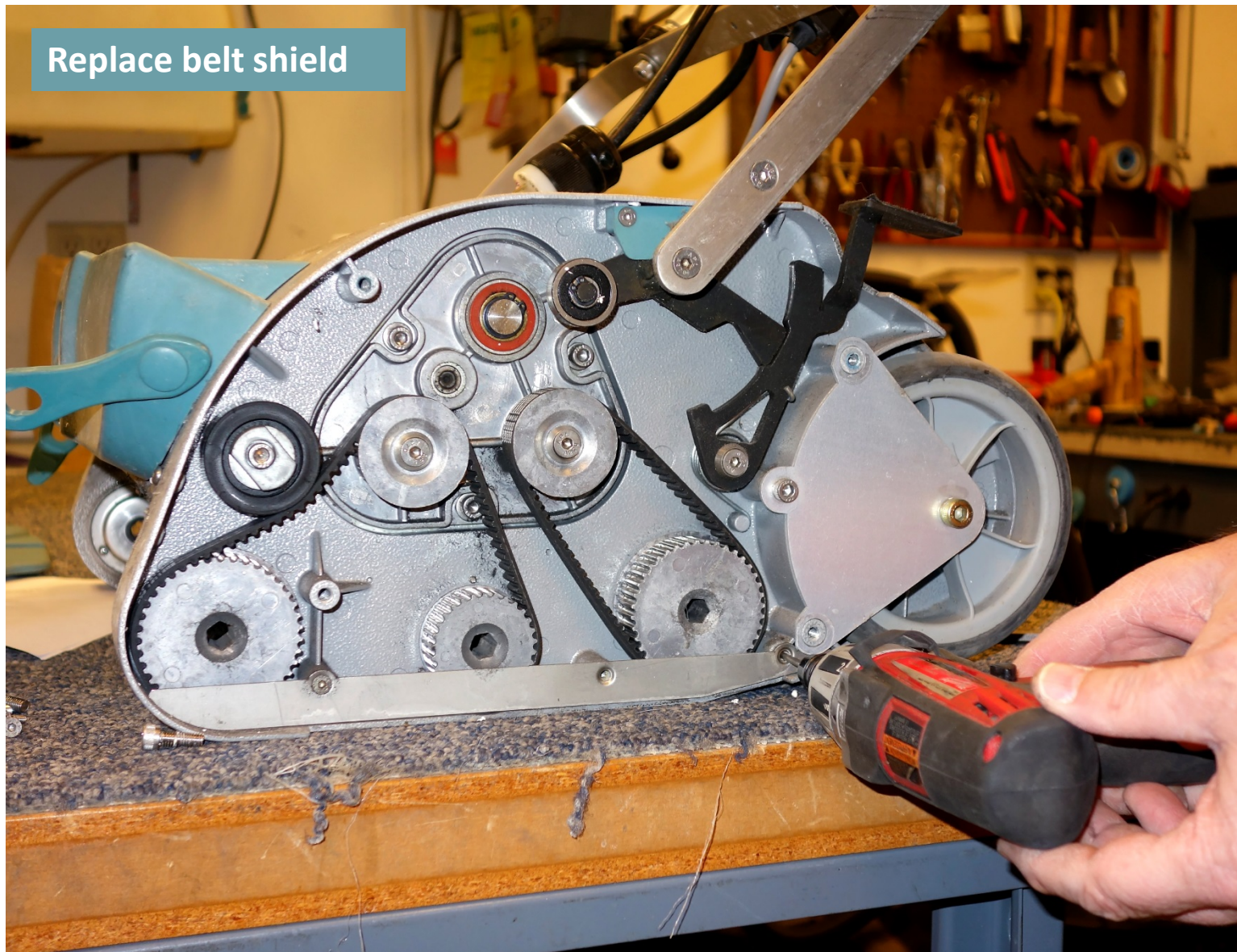



Replace drive cover assembly and test machine



